

GR.1

GR.2

Kit guarnizioni Seals kit 012002900000000

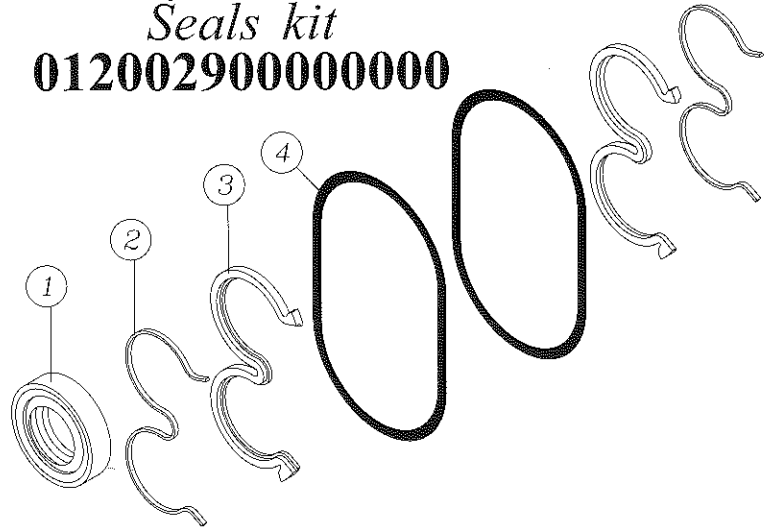

Motori reversibili Reversible motors	
Motori unidirezionali Unidirectional motors	◆
Pompe Pumps	◆
Applicabile a: Apply to:	

N.B.:

Part. 1: Ingrassare con LIPLEX GREASE 2 prima del montaggio
Greasing with LIPLEX GREASE 2 before the mounting

Q.tà Kit Kit Q.ty	Codice Kit Kit Code	Pos.	Codice Parte Part Code	Descrizione Description
1	012002900000000			Kit guarnizioni pompa in NBR 2 SP NBR sael kit for pump 2 SP
		1	BABSL 18307HP	Anello tenuta albero rotante Ø18 x Ø30 x 7 - 2 SP Shaft seal Ø18 x Ø30 x 7 - 2 SP
		2	01.022.29604.99	Antiestrusore per pompa 2 SP Back-up ring for pump 2 SP
		3	01.022.29603.99	Guarnizioni per boccola 2 SP Seal for shaft support 2 SP
		4	OR 90 145	Anello tenuta olio OR 90°Sh NBR 2.62x64.77 O-ring 90°Sh NBR 2.62x64.77

GR.3

Kit guarnizioni in VITON VITON seals kit 0120029000000009

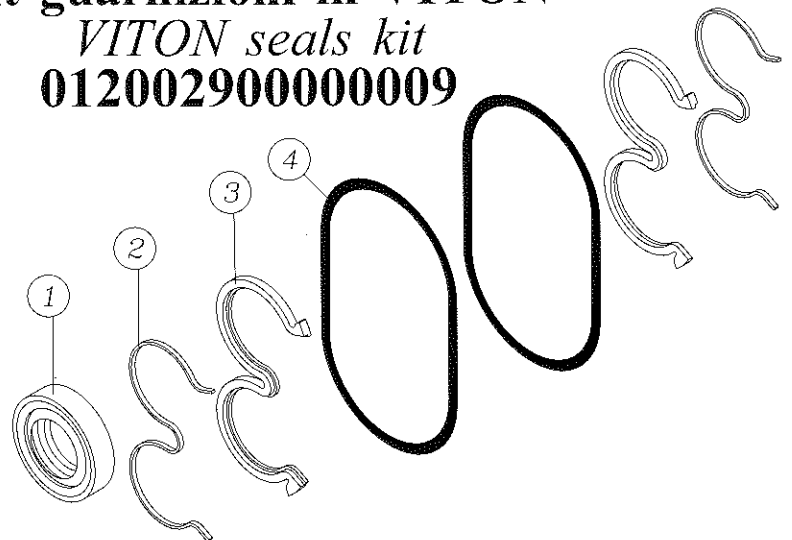

Motori reversibili Reversible motors	
Motori unidirezionali Unidirectional motors	◆
Pompe Pumps	◆
Applicabile a: Apply to:	

N.B.:

Part. 1: Ingrassare con LIPLEX GREASE 2 prima del montaggio
Greasing with LIPLEX GREASE 2 before the mounting

Q.tà Kit Kit Q.ty	Codice Kit Kit Code	Pos.	Codice Parte Part Code	Descrizione Description
1	0120029000000009			Kit guarnizioni in VITON per pompa 2 SP VITON sael kit for pump 2 SP
		1	A 18307VT	Anello tenuta albero rotante in VITON Ø18 x Ø30 x 7 - 2 SP VITON shaft sael Ø18 x Ø30 x 7 - 2 SP
		2	01.022.29604.99	Antiestrusore per pompa 2 SP Back-up ring for pump 2 SP
		3	0102229603VT99	Guarnizione in VITON per boccola 2 SP VITON seal for shaft support 2 SP
		4	OR V9 145	Anello tenuta olio in VITON 90°Sh 2.62x64.77 VITON O-ring 90°Sh 2.62x64.77

GR.4

TANDEM