

Dowel Pins, Unhardened

DIN 7 ISO 2338

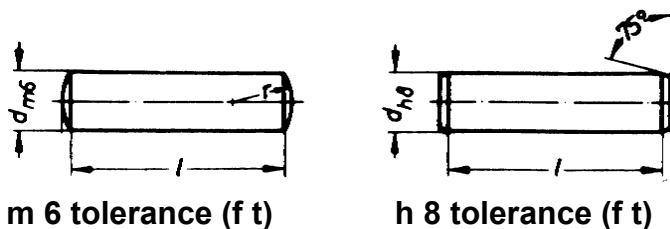

Material: Steel 1.0718 (AISI 12L13)

| Diameter | | | | | | | | | | | | | | | | | |
|----------|------|--------|------|--------|------|------|------|-------|-------|--------|--------|--------|--------|--------|--------|--------|-------|
| Ø 0.8 | Ø 1 | Ø 1.5 | Ø 2 | Ø 2.5 | Ø 3 | Ø 4 | Ø 5 | Ø 6 | Ø 8 | Ø 10 | Ø 12 | Ø 14 | Ø 16 | Ø 20 | Ø 25 | Ø 30 | |
| 0.8x4 | 1x4 | 1.5x4 | 2x4 | 2.5x4 | 3x4 | | | | | | | | | | | | |
| 0.8x6 | 1x6 | 1.5x6 | 2x6 | 2.5x6 | 3x6 | 4x6 | 5x6 | 6x6 | | | | | | | | | |
| 0.8x8 | 1x8 | 1.5x8 | 2x8 | 2.5x8 | 3x8 | 4x8 | 5x8 | 6x8 | | | | | | | | | |
| 0.8x10 | 1x10 | 1.5x10 | 2x10 | 2.5x10 | 3x10 | 4x10 | 5x10 | 6x10 | 8x10 | 10x10 | | | | | | | |
| 0.8x12 | 1x12 | 1.5x12 | 2x12 | 2.5x12 | 3x12 | 4x12 | 5x12 | 6x12 | 8x12 | 10x12 | 12x12 | | | | | | |
| 0.8x14 | 1x14 | 1.5x14 | 2x14 | 2.5x14 | 3x14 | 4x14 | 5x14 | 6x14 | 8x14 | 10x14 | 12x14 | | | | | | |
| 0.8x16 | 1x16 | 1.5x16 | 2x16 | 2.5x16 | 3x16 | 4x16 | 5x16 | 6x16 | 8x16 | 10x16 | 12x16 | | | | | | |
| 0.8x18 | 1x18 | 1.5x18 | 2x18 | 2.5x18 | 3x18 | 4x18 | 5x18 | 6x18 | 8x18 | 10x18 | 12x18 | | | | | | |
| 0.8x20 | 1x20 | 1.5x20 | 2x20 | 2.5x20 | 3x20 | 4x20 | 5x20 | 6x20 | 8x20 | 10x20 | 12x20 | 14x20 | 16x20 | 20x20 | | | |
| | | 1.5x22 | 2x22 | 2.5x22 | 3x22 | 4x22 | 5x22 | 6x22 | 8x22 | 10x22 | 12x22 | 14x22 | 16x22 | 20x22 | | | |
| | | 1.5x24 | 2x24 | 2.5x24 | 3x24 | 4x24 | 5x24 | 6x24 | 8x24 | 10x24 | 12x24 | 14x24 | 16x24 | 20x24 | | | |
| | | 1.5x26 | 2x26 | 2.5x26 | 3x26 | 4x26 | 5x26 | 6x26 | 8x26 | 10x26 | 12x26 | 14x26 | 16x26 | 20x26 | | | |
| | | 1.5x28 | 2x28 | 2.5x28 | 3x28 | 4x28 | 5x28 | 6x28 | 8x28 | 10x28 | 12x28 | 14x28 | 16x28 | 20x28 | | | |
| | | 1.5x30 | 2x30 | 2.5x30 | 3x30 | 4x30 | 5x30 | 6x30 | 8x30 | 10x30 | 12x30 | 14x30 | 16x30 | 20x30 | | | |
| | | 1.5x32 | 2x32 | 2.5x32 | 3x32 | 4x32 | 5x32 | 6x32 | 8x32 | 10x32 | 12x32 | 14x32 | 16x32 | 20x32 | 25x32 | 30x32 | |
| | | | | 2.5x36 | 3x36 | 4x36 | 5x36 | 6x36 | 8x36 | 10x36 | 12x36 | 14x36 | 16x36 | 20x36 | 25x36 | 30x36 | |
| | | | | 2.5x40 | 3x40 | 4x40 | 5x40 | 6x40 | 8x40 | 10x40 | 12x40 | 14x40 | 16x40 | 20x40 | 25x40 | 30x40 | |
| | | | | | 3x45 | 4x45 | 5x45 | 6x45 | 8x45 | 10x45 | 12x45 | 14x45 | 16x45 | 20x45 | 25x45 | 30x45 | |
| | | | | | | 3x50 | 4x50 | 5x50 | 6x50 | 8x50 | 10x50 | 12x50 | 14x50 | 16x50 | 20x50 | 25x50 | 30x50 |
| | | | | | | 3x55 | 4x55 | 5x55 | 6x55 | 8x55 | 10x55 | 12x55 | 14x55 | 16x55 | 20x55 | 25x55 | 30x55 |
| | | | | | | 3x60 | 4x60 | 5x60 | 6x60 | 8x60 | 10x60 | 12x60 | 14x60 | 16x60 | 20x60 | 25x60 | 30x60 |
| | | | | | | | | | 6x70 | 8x70 | 10x70 | 12x70 | 14x70 | 16x70 | 20x70 | 25x70 | 30x70 |
| | | | | | | | | | 6x80 | 8x80 | 10x80 | 12x80 | 14x80 | 16x80 | 20x80 | 25x80 | 30x80 |
| | | | | | | | | | 6x90 | 8x90 | 10x90 | 12x90 | 14x90 | 16x90 | 20x90 | 25x90 | 30x90 |
| | | | | | | | | | | | | | | | | | |
| | | | | | | | | 6x100 | 8x100 | 10x100 | 12x100 | 14x100 | 16x100 | 20x100 | 25x100 | 30x100 | |
| | | | | | | | | | 8x110 | 10x110 | 12x110 | 14x110 | 16x110 | 20x110 | 25x110 | 30x110 | |
| | | | | | | | | | | | | | | | 25x120 | 30x120 | |
| | | | | | | | | | | | | | | | | | |
| | | | | | | | | | | | | | | | 25x140 | 30x140 | |
| | | | | | | | | | | | | | | | 25x150 | 30x150 | |

Ordering Example:

DPU 2x30 m 6

DPU = DIN 7 Dowel Pin, Unhardened

2 = Ø2 mm diameter

30 = 30 mm long

m 6 = tolerance (fit)

Dowel Pins, Unhardened

DIN 7 ISO 2338

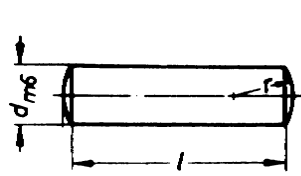

m 6 tolerance (f t)

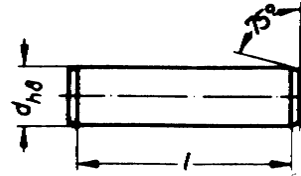

h 8 tolerance (f t)

Material: Stainless Steel 1.4305 (AISI 303)

| Diameter | | | | | | | | | | | |
|----------|------|--------|------|--------|------|------|------|------|------|--------|--------|
| Ø 0.8 | Ø 1 | Ø 1.5 | Ø 2 | Ø 2.5 | Ø 3 | Ø 4 | Ø 5 | Ø 6 | Ø 8 | Ø 10 | Ø 12 |
| 0.8x3 | 1x3 | 1.5x3 | | | | | | | | | |
| 0.8x4 | 1x4 | 1.5x4 | 2x4 | 2.5x4 | 3x4 | | | | | | |
| 0.8x5 | 1x5 | 1.5x5 | 2x5 | 2.5x5 | 3x5 | 4x5 | 5x5 | | | | |
| 0.8x6 | 1x6 | 1.5x6 | 2x6 | 2.5x6 | 3x6 | 4x6 | 5x6 | 6x6 | | | |
| 0.8x8 | 1x8 | 1.5x8 | 2x8 | 2.5x8 | 3x8 | 4x8 | 5x8 | 6x8 | 8x8 | | |
| 0.8x10 | 1x10 | 1.5x10 | 2x10 | 2.5x10 | 3x10 | 4x10 | 5x10 | 6x10 | 8x10 | 10x10 | |
| 0.8x12 | 1x12 | 1.5x12 | 2x12 | 2.5x12 | 3x12 | 4x12 | 5x12 | 6x12 | 8x12 | 10x12 | 12x12 |
| | | 1.5x14 | 2x14 | 2.5x14 | 3x14 | 4x14 | 5x14 | 6x14 | 8x14 | 10x14 | 12x14 |
| | | 1.5x16 | 2x16 | 2.5x16 | 3x16 | 4x16 | 5x16 | 6x16 | 8x16 | 10x16 | 12x16 |
| | | | 2x18 | 2.5x18 | 3x18 | 4x18 | 5x18 | 6x18 | 8x18 | 10x18 | 12x18 |
| | | | 2x20 | 2.5x20 | 3x20 | 4x20 | 5x20 | 6x20 | 8x20 | 10x20 | 12x20 |
| | | | 2x24 | 2.5x24 | 3x24 | 4x24 | 5x24 | 6x24 | 8x24 | 10x24 | 12x24 |
| | | | | | 3x28 | 4x28 | 5x28 | 6x28 | 8x28 | 10x28 | 12x28 |
| | | | | | 3x30 | 4x30 | 5x30 | 6x30 | 8x30 | 10x30 | 12x30 |
| | | | | | | 4x32 | 5x32 | 6x32 | 8x32 | 10x32 | 12x32 |
| | | | | | | 4x36 | 5x36 | 6x36 | 8x36 | 10x36 | 12x36 |
| | | | | | | 4x40 | 5x40 | 6x40 | 8x40 | 10x40 | 12x40 |
| | | | | | | 4x45 | 5x45 | 6x45 | 8x45 | 10x45 | 12x45 |
| | | | | | | 4x50 | 5x50 | 6x50 | 8x50 | 10x50 | 12x50 |
| | | | | | | | 5x55 | 6x55 | 8x55 | 10x55 | 12x55 |
| | | | | | | | 5x60 | 6x60 | 8x60 | 10x60 | 12x60 |
| | | | | | | | | | 8x70 | 10x70 | 12x70 |
| | | | | | | | | | 8x80 | 10x80 | 12x80 |
| | | | | | | | | | | 10x90 | 12x90 |
| | | | | | | | | | | 10x100 | 12x100 |

Ordering Example:

DP303SS 2x10 h 8

DP303SS = DIN 7 Dowel Pin,

303 Stainless Steel

2 = Ø2 mm diameter

10 = 10 mm long

h 8 = tolerance (fit)

Dowel Pins, Unhardened

DIN 7 ISO 2338

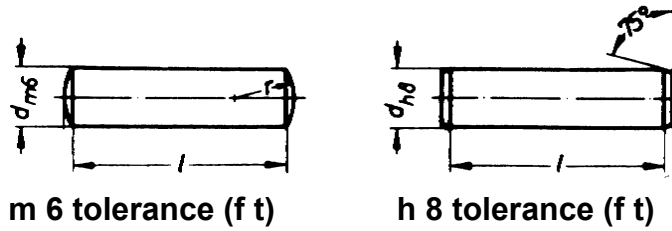

Material: Stainless Steel 1.4571 (AISI 316)

| Diameter | | | | | | | | | | |
|----------|--------|------|--------|------|------|------|------|------|--------|--------|
| Ø 1 | Ø 1.5 | Ø 2 | Ø 2.5 | Ø 3 | Ø 4 | Ø 5 | Ø 6 | Ø 8 | Ø 10 | Ø 12 |
| 1x3 | 1.5x3 | | | | | | | | | |
| 1x4 | 1.5x4 | 2x4 | 2.5x4 | 3x4 | | | | | | |
| 1x5 | 1.5x5 | 2x5 | 2.5x5 | 3x5 | 4x5 | | | | | |
| 1x6 | 1.5x6 | 2x6 | 2.5x6 | 3x6 | 4x6 | 5x6 | | | | |
| 1x8 | 1.5x8 | 2x8 | 2.5x8 | 3x8 | 4x8 | 5x8 | 6x8 | | | |
| 1x10 | 1.5x10 | 2x10 | 2.5x10 | 3x10 | 4x10 | 5x10 | 6x10 | 8x10 | | |
| 1x12 | 1.5x12 | 2x12 | 2.5x12 | 3x12 | 4x12 | 5x12 | 6x12 | 8x12 | 10x12 | |
| | 1.5x14 | 2x14 | 2.5x14 | 3x14 | 4x14 | 5x14 | 6x14 | 8x14 | 10x14 | 12x14 |
| | 1.5x16 | 2x16 | 2.5x16 | 3x16 | 4x16 | 5x16 | 6x16 | 8x16 | 10x16 | 12x16 |
| | | | 2.5x18 | 3x18 | 4x18 | 5x18 | 6x18 | 8x18 | 10x18 | 12x18 |
| | | | 2.5x20 | 3x20 | 4x20 | 5x20 | 6x20 | 8x20 | 10x20 | 12x20 |
| | | | 2.5x24 | 3x24 | 4x24 | 5x24 | 6x24 | 8x24 | 10x24 | 12x24 |
| | | | | 3x28 | 4x28 | 5x28 | 6x28 | 8x28 | 10x28 | 12x28 |
| | | | | 3x30 | 4x30 | 5x30 | 6x30 | 8x30 | 10x30 | 12x30 |
| | | | | 3x32 | 4x32 | 5x32 | 6x32 | 8x32 | 10x32 | 12x32 |
| | | | | | 4x36 | 5x36 | 6x36 | 8x36 | 10x36 | 12x36 |
| | | | | | 4x40 | 5x40 | 6x40 | 8x40 | 10x40 | 12x40 |
| | | | | | | 5x45 | 6x45 | 8x45 | 10x45 | 12x45 |
| | | | | | | 5x50 | 6x50 | 8x50 | 10x50 | 12x50 |
| | | | | | | | 6x55 | 8x55 | 10x55 | 12x55 |
| | | | | | | | 6x60 | 8x60 | 10x60 | 12x60 |
| | | | | | | | | 8x70 | 10x70 | 12x70 |
| | | | | | | | | 8x80 | 10x80 | 12x80 |
| | | | | | | | | | 10x90 | 12x90 |
| | | | | | | | | | 10x100 | 12x100 |

Ordering Example:
 DP316SS 2x10 h 8
 DP316SS = DIN 7 Dowel Pin,
 316 Stainless Steel
 2 = Ø2 mm diameter
 10 = 10 mm long
 h 8 = tolerance (fit)



Dowel Pins, Hardened

DIN 6325 ISO 8734

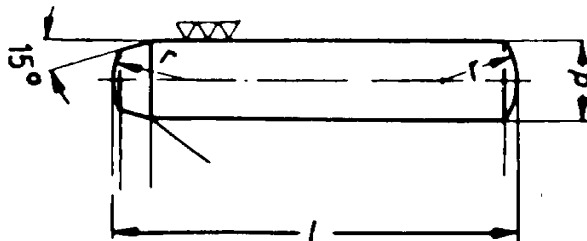

Material: Steel 1.3505 (AISI 52100) Hardness: HRC 60±2

| Diameter | | | | | | | | | | | | | |
|----------|--------|------|--------|------|------|------|-------|-------|--------|--------|--------|--------|--------|
| Ø 1 | Ø 1.5 | Ø 2 | Ø 2.5 | Ø 3 | Ø 4 | Ø 5 | Ø 6 | Ø 8 | Ø 10 | Ø 12 | Ø 14 | Ø 16 | Ø 20 |
| 1x4 | | | | | | | | | | | | | |
| 1x5 | 1.5x5 | | | | | | | | | | | | |
| 1x6 | 1.5x6 | 2x6 | 2.5x6 | 3x6 | 4x6 | | | | | | | | |
| 1x8 | 1.5x8 | 2x8 | 2.5x8 | 3x8 | 4x8 | 5x8 | | | | | | | |
| 1x10 | 1.5x10 | 2x10 | 2.5x10 | 3x10 | 4x10 | 5x10 | 6x10 | | | | | | |
| 1x12 | 1.5x12 | 2x12 | 2.5x12 | 3x12 | 4x12 | 5x12 | 6x12 | | | | | | |
| | 1.5x14 | 2x14 | 2.5x14 | 3x14 | 4x14 | 5x14 | 6x14 | 8x14 | | | | | |
| | 1.5x16 | 2x16 | 2.5x16 | 3x16 | 4x16 | 5x16 | 6x16 | 8x16 | | | | | |
| | 1.5x18 | 2x18 | 2.5x18 | 3x18 | 4x18 | 5x18 | 6x18 | 8x18 | | | | | |
| | 1.5x20 | 2x20 | 2.5x20 | 3x20 | 4x20 | 5x20 | 6x20 | 8x20 | 10x20 | 12x20 | | | |
| | 1.5x22 | 2x22 | 2.5x22 | 3x22 | 4x22 | 5x22 | 6x22 | 8x22 | 10x22 | 12x22 | | | |
| | 1.5x24 | 2x24 | 2.5x24 | 3x24 | 4x24 | 5x24 | 6x24 | 8x24 | 10x24 | 12x24 | 14x24 | 16x24 | |
| | 1.5x26 | 2x26 | 2.5x26 | 3x26 | 4x26 | 5x26 | 6x26 | 8x26 | 10x26 | 12x26 | 14x26 | 16x26 | |
| | 1.5x28 | 2x28 | 2.5x28 | 3x28 | 4x28 | 5x28 | 6x28 | 8x28 | 10x28 | 12x28 | 14x28 | 16x28 | |
| | 1.5x30 | 2x30 | 2.5x30 | 3x30 | 4x30 | 5x30 | 6x30 | 8x30 | 10x30 | 12x30 | 14x30 | 16x30 | |
| | | 2x32 | 2.5x32 | 3x32 | 4x32 | 5x32 | 6x32 | 8x32 | 10x32 | 12x32 | 14x32 | 16x32 | |
| | | 2x36 | 2.5x36 | 3x36 | 4x36 | 5x36 | 6x36 | 8x36 | 10x36 | 12x36 | 14x36 | 16x36 | |
| | | 2x40 | 2.5x40 | 3x40 | 4x40 | 5x40 | 6x40 | 8x40 | 10x40 | 12x40 | 14x40 | 16x40 | 20x40 |
| | | | 2.5x45 | 3x45 | 4x45 | 5x45 | 6x45 | 8x45 | 10x45 | 12x45 | 14x45 | 16x45 | 20x45 |
| | | | 2.5x50 | 3x50 | 4x50 | 5x50 | 6x50 | 8x50 | 10x50 | 12x50 | 14x50 | 16x50 | 20x50 |
| | | | | 3x55 | 4x55 | 5x55 | 6x55 | 8x55 | 10x55 | 12x55 | 14x55 | 16x55 | 20x55 |
| | | | | 3x60 | 4x60 | 5x60 | 6x60 | 8x60 | 10x60 | 12x60 | 14x60 | 16x60 | 20x60 |
| | | | | | | | 6x70 | 8x70 | 10x70 | 12x70 | 14x70 | 16x70 | 20x70 |
| | | | | | | | 6x80 | 8x80 | 10x80 | 12x80 | 14x80 | 16x80 | 20x80 |
| | | | | | | | 6x90 | 8x90 | 10x90 | 12x90 | 14x90 | 16x90 | 20x90 |
| | | | | | | | 6x100 | 8x100 | 10x100 | 12x100 | 14x100 | 16x100 | 20x100 |
| | | | | | | | | 8x110 | 10x110 | 12x110 | 14x110 | 16x110 | 20x110 |
| | | | | | | | | 8x120 | 10x120 | 12x120 | 14x120 | 16x120 | 20x120 |

Ordering Example:

DPH 2x30

DPH = DIN 6325 Dowel Pin, Hardened

2 = Ø2 mm diameter

30 = 30 mm long

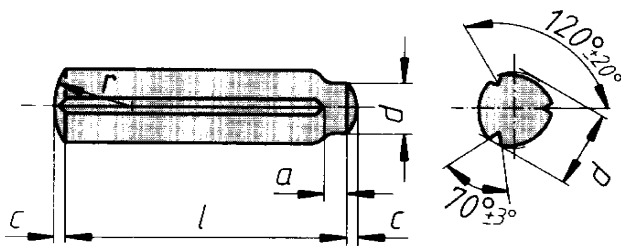

Grooved Pin, Full Length Parallel Groove with Pilot DIN 1470 ISO 8739

Material: Steel 1.0718 (AISI 12L13)

| Diameter | | | | | | | | | | | | |
|----------|----------------------------|----------------------|----------------------------|----------------------|----------------------|----------------------|----------------------|----------------------|----------------------------|----------------------------|----------------------------|----------------------------|
| | Ø 1.5 | Ø 2 | Ø 2.5 | Ø 3 | Ø 4 | Ø 5 | Ø 6 | Ø 8 | Ø 10 | Ø 12 | Ø 14 | Ø 16 |
| a | 0.7 | 0.7 | 1 | 1 | 1.5 | 1.5 | 2 | 2 | 2.5 | 2.5 | 2.5 | 2.5 |
| c | 0.2 | 0.25 | 0.3 | 0.4 | 0.5 | 0.6 | 0.8 | 1 | 1.2 | 1.6 | 1.6 | 2 |
| kN* | 1.60 | 2.85 | 4.25 | 6.15 | 10.6 | 16.5 | 22.8 | 40.5 | 63.2 | 91.0 | 124 | 156.8 |
| | 1.5x4 1.5x5 1.5x6 | 2x4 2x5 2x6 | 2.5x6 | 3x6 | 4x6 | | | | | | | |
| | 1.5x8 1.5x10 1.5x12 | 2x8 2x10 2x12 | 2.5x8 2.5x10 2.5x12 | 3x8 3x10 3x12 | 4x8 4x10 4x12 | 5x8 5x10 5x12 | 6x8 6x10 6x12 | 8x10 8x12 | | | | |
| | 1.5x14 1.5x16 1.5x18 | 2x14 2x16 2x18 | 2.5x14 2.5x16 2.5x18 | 3x14 3x16 3x18 | 4x14 4x16 4x18 | 5x14 5x16 5x18 | 6x14 6x16 6x18 | 8x14 8x16 8x18 | 10x14 10x16 10x18 | 12x14 12x16 12x18 | | |
| | 1.5x20 | 2x20 2x22 2x24 | 2.5x20 2.5x22 2.5x24 | 3x20 3x22 3x24 | 4x20 4x22 4x24 | 5x20 5x22 5x24 | 6x20 6x22 6x24 | 8x20 8x22 8x24 | 10x20 10x22 | 12x20 12x22 | 14x22 | 16x22 |
| | | 2x26 2x28 | 2.5x26 2.5x28 | 3x26 3x28 | 4x26 4x28 | 5x26 5x28 | 6x26 6x28 | 8x26 8x28 | 10x25 10x28 | 12x25 12x28 | 14x25 14x28 | 16x25 16x28 |
| | | 2x30 | 2.5x30 | 3x30 | 4x30 4x32 4x36 | 5x30 5x32 5x36 | 6x30 6x32 6x36 | 8x30 8x32 8x36 | 10x30 10x32 10x36 | 12x30 12x32 12x36 | 14x30 14x32 14x36 | 16x30 16x32 16x36 |
| | | | | | 4x40 4x45 4x50 | 5x40 5x45 5x50 | 6x40 6x45 6x50 | 8x40 8x45 8x50 | 10x40 10x45 10x50 | 12x40 12x45 12x50 | 14x40 14x45 14x50 | 16x40 16x45 16x50 |
| | | | | | | | 6x55 6x60 | 8x55 8x60 8x65 | 10x55 10x60 10x65 | 12x55 12x60 12x65 | 14x55 14x60 14x65 | 16x55 16x60 16x65 |
| | | | | | | | | 8x70 | 10x70 10x80 10x90 | 12x70 12x80 12x90 | 14x70 14x80 14x90 | 16x70 16x80 16x90 |
| | | | | | | | | | 10x100 10x110 10x120 | 12x100 12x110 12x120 | 14x100 14x110 14x120 | 16x100 16x110 16x120 |

Ordering Example:

GPFLP 8x40

GPFLP = DIN 1470 Grooved Pin,
Full Length Parallel Groove with Pilot

8 = Ø8 mm diameter

40 = 40 mm long

kN* = Sheer Force



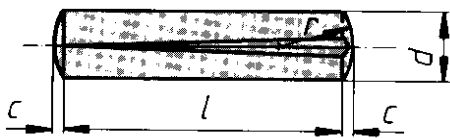

Grooved Pin, Full Length Taper Groove DIN 1471 ISO 8744

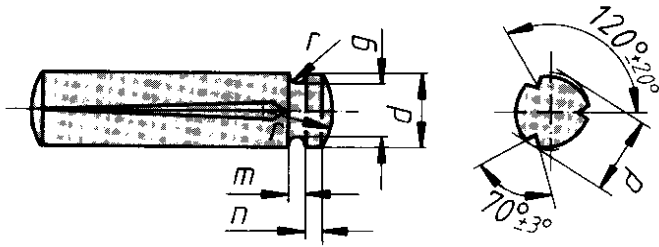

Inquire for Grooved Neck

Material: Steel 1.0718 (AISI 12L13)

| | | Diameter | | | | | | | | | | | |
|----------|--------|----------|--------|-------|------|------|------|------|-------|--------|--------|--------|--------|
| | | Ø 1.5 | Ø 2 | Ø 2.5 | Ø 3 | Ø 4 | Ø 5 | Ø 6 | Ø 8 | Ø 10 | Ø 12 | Ø 14 | Ø 16 |
| c kN* | | 0.2 | 0.25 | 0.3 | 0.4 | 0.5 | 0.63 | 0.8 | 1 | 1.2 | 1.6 | 1.6 | 2 |
| | | 1.60 | 2.85 | 4.25 | 6.15 | 10.6 | 16.5 | 22.8 | 40.5 | 63.2 | 91.0 | 124 | 156.8 |
| | 1.5x4 | 2x4 | | | | | | | | | | | |
| | 1.5x5 | 2x5 | | | | | | | | | | | |
| | 1.5x6 | 2x6 | 2.5x6 | 3x6 | 4x6 | | | | | | | | |
| | 1.5x8 | 2x8 | 2.5x8 | 3x8 | 4x8 | 5x8 | 6x8 | | | | | | |
| | 1.5x10 | 2x10 | 2.5x10 | 3x10 | 4x10 | 5x10 | 6x10 | 8x10 | | | | | |
| | 1.5x12 | 2x12 | 2.5x12 | 3x12 | 4x12 | 5x12 | 6x12 | 8x12 | | | | | |
| | 1.5x14 | 2x14 | 2.5x14 | 3x14 | 4x14 | 5x14 | 6x14 | 8x14 | 10x14 | 12x14 | | | |
| | 1.5x16 | 2x16 | 2.5x16 | 3x16 | 4x16 | 5x16 | 6x16 | 8x16 | 10x16 | 12x16 | | | |
| | 1.5x18 | 2x18 | 2.5x18 | 3x18 | 4x18 | 5x18 | 6x18 | 8x18 | 10x18 | 12x18 | | | |
| | 1.5x20 | 2x20 | 2.5x20 | 3x20 | 4x20 | 5x20 | 6x20 | 8x20 | 10x20 | 12x20 | | | |
| | | 2x22 | 2.5x22 | 3x22 | 4x22 | 5x22 | 6x22 | 8x22 | 10x22 | 12x22 | 14x22 | 16x22 | |
| | | 2x24 | 2.5x24 | 3x24 | 4x24 | 5x24 | 6x24 | 8x24 | | | | | |
| | | 2x26 | 2.5x26 | 3x26 | 4x26 | 5x26 | 6x26 | 8x26 | 10x25 | 12x25 | 14x25 | 16x25 | |
| | | 2x28 | 2.5x28 | 3x28 | 4x28 | 5x28 | 6x28 | 8x28 | 10x28 | 12x28 | 14x28 | 16x28 | |
| | | 2x30 | 2.5x30 | 3x30 | 4x30 | 5x30 | 6x30 | 8x30 | 10x30 | 12x30 | 14x30 | 16x30 | |
| | | | | | 4x32 | 5x32 | 6x32 | 8x32 | 10x32 | 12x32 | 14x32 | 16x32 | |
| | | | | | 4x36 | 5x36 | 6x36 | 8x36 | 10x36 | 12x36 | 14x36 | 16x36 | |
| | | | | | 4x40 | 5x40 | 6x40 | 8x40 | 10x40 | 12x40 | 14x40 | 16x40 | |
| | | | | | 4x45 | 5x45 | 6x45 | 8x45 | 10x45 | 12x45 | 14x45 | 16x45 | |
| | | | | | 4x50 | 5x50 | 6x50 | 8x50 | 10x50 | 12x50 | 14x50 | 16x50 | |
| | | | | | | | 6x55 | 8x55 | 10x55 | 12x55 | 14x55 | 16x55 | |
| | | | | | | | 6x60 | 8x60 | 10x60 | 12x60 | 14x60 | 16x60 | |
| | | | | | | | | 8x65 | 10x65 | 12x65 | 14x65 | 16x65 | |
| | | | | | | | | 8x70 | 10x70 | 12x70 | 14x70 | 16x70 | |
| | | | | | | | | | 10x80 | 12x80 | 14x80 | 16x80 | |
| | | | | | | | | | 10x90 | 12x90 | 14x90 | 16x90 | |
| | | | | | | | | | | 10x100 | 12x100 | 14x100 | 16x100 |
| | | | | | | | | | | 10x110 | 12x110 | 14x110 | 16x110 |
| | | | | | | | | | | 10x120 | 12x120 | 14x120 | 16x120 |

Ordering Example:

GPFLT 8x40

GPFLT = DIN 1471 Grooved Pin,

Full Length Tapered Groove

8 = Ø8 mm diameter

40 = 40 mm long

kN* = Shear Force

 American Metric® Corporation

GROUP: 063

1-063 - 70624

680

Grooved Pin, Half Length Taper Groove DIN 1472 ISO 8745

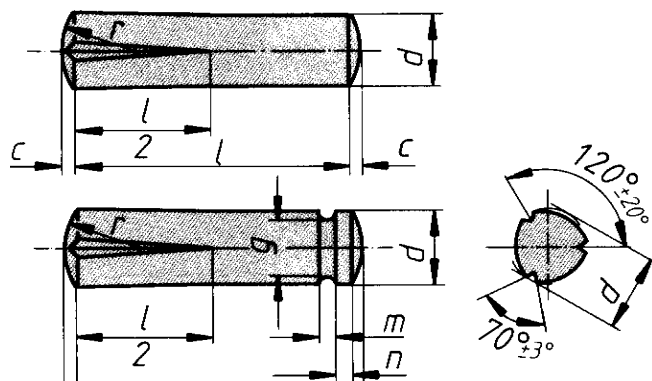

Inquire for Grooved Neck

Material: Steel 1.0718 (AISI 12L13)

| | | Diameter | | | | | | | | | | | |
|----------|--------|----------|--------|-------|------|------|------|------|-------|--------|--------|--------|--------|
| | | Ø 1.5 | Ø 2 | Ø 2.5 | Ø 3 | Ø 4 | Ø 5 | Ø 6 | Ø 8 | Ø 10 | Ø 12 | Ø 14 | Ø 16 |
| C kN* | | 0.2 | 0.25 | 0.3 | 0.4 | 0.5 | 0.63 | 0.8 | 1 | 1.2 | 1.6 | 1.6 | 2 |
| | | 1.60 | 2.85 | 4.25 | 6.15 | 10.6 | 16.5 | 22.8 | 40.5 | 63.2 | 91.0 | 124 | 156.8 |
| | 1.5x4 | 2x4 | | | | | | | | | | | |
| | 1.5x5 | 2x5 | | | | | | | | | | | |
| | 1.5x6 | 2x6 | 2.5x6 | 3x6 | 4x6 | | | | | | | | |
| | 1.5x8 | 2x8 | 2.5x8 | 3x8 | 4x8 | 5x8 | 6x8 | | | | | | |
| | 1.5x10 | 2x10 | 2.5x10 | 3x10 | 4x10 | 5x10 | 6x10 | 8x10 | | | | | |
| | 1.5x12 | 2x12 | 2.5x12 | 3x12 | 4x12 | 5x12 | 6x12 | 8x12 | | | | | |
| | 1.5x14 | 2x14 | 2.5x14 | 3x14 | 4x14 | 5x14 | 6x14 | 8x14 | 10x14 | 12x14 | | | |
| | 1.5x16 | 2x16 | 2.5x16 | 3x16 | 4x16 | 5x16 | 6x16 | 8x16 | 10x16 | 12x16 | | | |
| | 1.5x18 | 2x18 | 2.5x18 | 3x18 | 4x18 | 5x18 | 6x18 | 8x18 | 10x18 | 12x18 | | | |
| | 1.5x20 | 2x20 | 2.5x20 | 3x20 | 4x20 | 5x20 | 6x20 | 8x20 | 10x20 | 12x20 | | | |
| | | 2x22 | 2.5x22 | 3x22 | 4x22 | 5x22 | 6x22 | 8x22 | 10x22 | 12x22 | 14x22 | 16x22 | |
| | | 2x24 | 2.5x24 | 3x24 | 4x24 | 5x24 | 6x24 | 8x24 | | | | | |
| | | | | | | | | | 10x25 | 12x25 | 14x25 | 16x25 | |
| | | 2x26 | 2.5x26 | 3x26 | 4x26 | 5x26 | 6x26 | 8x26 | | | | | |
| | | 2x28 | 2.5x28 | 3x28 | 4x28 | 5x28 | 6x28 | 8x28 | 10x28 | 12x28 | 14x28 | 16x28 | |
| | | | | | | | | | | | | | |
| | | 2x30 | 2.5x30 | 3x30 | 4x30 | 5x30 | 6x30 | 8x30 | 10x30 | 12x30 | 14x30 | 16x30 | |
| | | | | | 4x32 | 5x32 | 6x32 | 8x32 | 10x32 | 12x32 | 14x32 | 16x32 | |
| | | | | | 4x36 | 5x36 | 6x36 | 8x36 | 10x36 | 12x36 | 14x36 | 16x36 | |
| | | | | | | | | | | | | | |
| | | | | | 4x40 | 5x40 | 6x40 | 8x40 | 10x40 | 12x40 | 14x40 | 16x40 | |
| | | | | | 4x45 | 5x45 | 6x45 | 8x45 | 10x45 | 12x45 | 14x45 | 16x45 | |
| | | | | | 4x50 | 5x50 | 6x50 | 8x50 | 10x50 | 12x50 | 14x50 | 16x50 | |
| | | | | | | | | | | | | | |
| | | | | | | | | 6x55 | 8x55 | 10x55 | 12x55 | 14x55 | 16x55 |
| | | | | | | | | 6x60 | 8x60 | 10x60 | 12x60 | 14x60 | 16x60 |
| | | | | | | | | | 8x65 | 10x65 | 12x65 | 14x65 | 16x65 |
| | | | | | | | | | | | | | |
| | | | | | | | | 8x70 | 10x70 | 12x70 | 14x70 | 16x70 | |
| | | | | | | | | | 10x80 | 12x80 | 14x80 | 16x80 | |
| | | | | | | | | | 10x90 | 12x90 | 14x90 | 16x90 | |
| | | | | | | | | | | | | | |
| | | | | | | | | | | 10x100 | 12x100 | 14x100 | 16x100 |
| | | | | | | | | | | 10x110 | 12x110 | 14x110 | 16x110 |
| | | | | | | | | | | 10x120 | 12x120 | 14x120 | 16x120 |

Ordering Example:

GPHLT 8x40

GPHLT = DIN 1472 Grooved Pin,
Half Length Taper Groove

8 = Ø8 mm diameter

40 = 40 mm long

kN* = Sheer Force

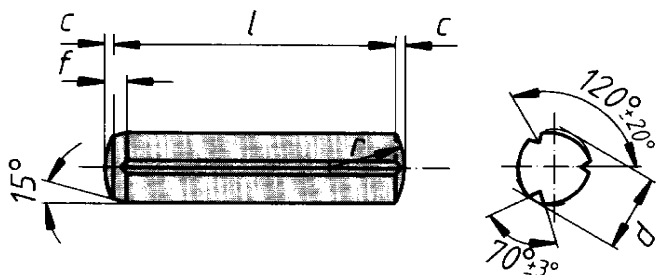

Grooved Pin, Full Length Parallel Groove with Chamfer DIN 1473 ISO 8740

Material: Steel 1.0718 (AISI 12L13)

| | | Diameter | | | | | | | | | | | | | |
|---------------|--------|----------|--------|-------|--------|--------|------|------|------|------|-------|--------|--------|--------|--------|
| | | Ø 1.0 | Ø 1.2 | Ø 1.5 | Ø 2 | Ø 2.5 | Ø 3 | Ø 4 | Ø 5 | Ø 6 | Ø 8 | Ø 10 | Ø 12 | Ø 14 | Ø 16 |
| c f kN* | | 0.12 | 0.16 | 0.2 | 0.25 | 0.3 | 0.4 | 0.5 | 0.6 | 0.8 | 1 | 1.2 | 1.6 | 1.6 | 2 |
| | | 0.57 | 0.6 | 0.8 | 0.9 | 1.2 | 1.3 | 1.8 | 2 | 2.5 | 2.8 | 3.5 | 3.7 | 4 | 4.3 |
| | | 0.70 | 1.00 | 1.60 | 2.85 | 4.25 | 6.15 | 10.6 | 16.5 | 22.8 | 40.5 | 63.2 | 91.0 | 124 | 156.8 |
| | 1.0x4 | 1.2x4 | 1.5x4 | 2x4 | | | | | | | | | | | |
| | 1.0x5 | 1.2x5 | 1.5x5 | 2x5 | | | | | | | | | | | |
| | 1.0x6 | 1.2x6 | 1.5x6 | 2x6 | 2.5x6 | 3x6 | 4x6 | | | | | | | | |
| | 1.0x8 | 1.2x8 | 1.5x8 | 2x8 | 2.5x8 | 3x8 | 4x8 | 5x8 | 6x8 | | | | | | |
| | 1.0x10 | 1.2x10 | 1.5x10 | 2x10 | 2.5x10 | 3x10 | 4x10 | 5x10 | 6x10 | 8x10 | | | | | |
| | | | 1.5x12 | 2x12 | 2.5x12 | 3x12 | 4x12 | 5x12 | 6x12 | 8x12 | | | | | |
| | | | 1.5x14 | 2x14 | 2.5x14 | 3x14 | 4x14 | 5x14 | 6x14 | 8x14 | 10x14 | 12x14 | | | |
| | | | 1.5x16 | 2x16 | 2.5x16 | 3x16 | 4x16 | 5x16 | 6x16 | 8x16 | 10x16 | 12x16 | | | |
| | | | 1.5x18 | 2x18 | 2.5x18 | 3x18 | 4x18 | 5x18 | 6x18 | 8x18 | 10x18 | 12x18 | | | |
| | | | 1.5x20 | 2x20 | 2.5x20 | 3x20 | 4x20 | 5x20 | 6x20 | 8x20 | 10x20 | 12x20 | | | |
| | | | | 2x22 | 2.5x22 | 3x22 | 4x22 | 5x22 | 6x22 | 8x22 | 10x22 | 12x22 | | | |
| | | | | 2x24 | 2.5x24 | 3x24 | 4x24 | 5x24 | 6x24 | 8x24 | | | | | |
| | | | | | | | | | | | 10x25 | 12x25 | 14x25 | 16x25 | |
| | | | | | | | | | | | | | | | |
| | | | | | 2x26 | 2.5x26 | 3x26 | 4x26 | 5x26 | 6x26 | 8x26 | | | | |
| | | | | | 2x28 | 2.5x28 | 3x28 | 4x28 | 5x28 | 6x28 | 8x28 | 10x28 | 12x28 | 14x28 | 16x28 |
| | | | | | | | | | | | | | | | |
| | | | | | 2x30 | 2.5x30 | 3x30 | 4x30 | 5x30 | 6x30 | 8x30 | 10x30 | 12x30 | 14x30 | 16x30 |
| | | | | | | | | 4x32 | 5x32 | 6x32 | 8x32 | 10x32 | 12x32 | 14x32 | 16x32 |
| | | | | | | | | 4x36 | 5x36 | 6x36 | 8x36 | 10x36 | 12x36 | 14x36 | 16x36 |
| | | | | | | | | | | | | | | | |
| | | | | | | | | 4x40 | 5x40 | 6x40 | 8x40 | 10x40 | 12x40 | 14x40 | 16x40 |
| | | | | | | | | 4x45 | 5x45 | 6x45 | 8x45 | 10x45 | 12x45 | 14x45 | 16x45 |
| | | | | | | | | 4x50 | 5x50 | 6x50 | 8x50 | 10x50 | 12x50 | 14x50 | 16x50 |
| | | | | | | | | | | | | | | | |
| | | | | | | | | | | 6x55 | 8x55 | 10x55 | 12x55 | 14x55 | 16x55 |
| | | | | | | | | | | 6x60 | 8x60 | 10x60 | 12x60 | 14x60 | 16x60 |
| | | | | | | | | | | | 8x65 | 10x65 | 12x65 | 14x65 | 16x65 |
| | | | | | | | | | | | | | | | |
| | | | | | | | | | | | 8x70 | 10x70 | 12x70 | 14x70 | 16x70 |
| | | | | | | | | | | | | 10x80 | 12x80 | 14x80 | 16x80 |
| | | | | | | | | | | | | 10x90 | 12x90 | 14x90 | 16x90 |
| | | | | | | | | | | | | | | | |
| | | | | | | | | | | | | 10x100 | 12x100 | 14x100 | 16x100 |
| | | | | | | | | | | | | 10x110 | 12x110 | 14x110 | 16x110 |
| | | | | | | | | | | | | 10x120 | 12x120 | 14x120 | 16x120 |

Ordering Example:

GPFLCH 8x40
 GPFLCH = DIN 1473 Grooved Pin, Full
 Length Parallel Groove with Chamfer
 8 = Ø8 mm diameter
 40 = 40 mm long

kN* = Shear Force

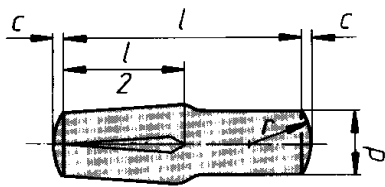

Grooved Pin, DIN 1475 ISO 8742

Half Length Reverse Groove DIN 1474 ISO 8741

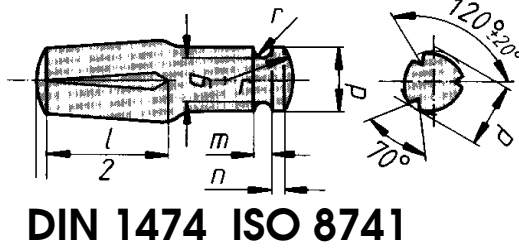
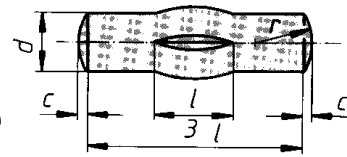

Third Length Center Groove DIN 1475 ISO 8742

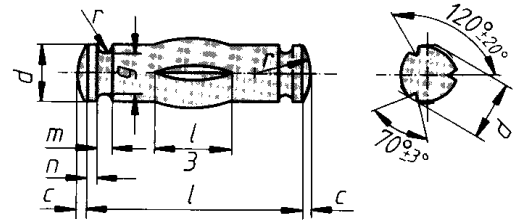

Material: Steel 1.0718 (AISI 12L13)

| | | Diameter | | | | | | | | | | | |
|---|--------|----------|--------|-------|------|------|------|------|-------|--------|--------|--------|--------|
| | | Ø 1.5 | Ø 2 | Ø 2.5 | Ø 3 | Ø 4 | Ø 5 | Ø 6 | Ø 8 | Ø 10 | Ø 12 | Ø 14 | Ø 16 |
| c | | 0.2 | 0.25 | 0.3 | 0.4 | 0.5 | 0.63 | 0.8 | 1 | 1.2 | 1.6 | 1.6 | 2 |
| | kn* | 1.60 | 2.85 | 4.25 | 6.15 | 10.6 | 16.5 | 22.8 | 40.5 | 63.2 | 91.0 | 124 | 156.8 |
| | 1.5x4 | 2x4 | | | | | | | | | | | |
| | 1.5x5 | 2x5 | | | | | | | | | | | |
| | 1.5x6 | 2x6 | 2.5x6 | 3x6 | 4x6 | | | | | | | | |
| | 1.5x8 | 2x8 | 2.5x8 | 3x8 | 4x8 | 5x8 | 6x8 | | | | | | |
| | 1.5x10 | 2x10 | 2.5x10 | 3x10 | 4x10 | 5x10 | 6x10 | 8x10 | | | | | |
| | 1.5x12 | 2x12 | 2.5x12 | 3x12 | 4x12 | 5x12 | 6x12 | 8x12 | | | | | |
| | 1.5x14 | 2x14 | 2.5x14 | 3x14 | 4x14 | 5x14 | 6x14 | 8x14 | 10x14 | 12x14 | | | |
| | 1.5x16 | 2x16 | 2.5x16 | 3x16 | 4x16 | 5x16 | 6x16 | 8x16 | 10x16 | 12x16 | | | |
| | 1.5x18 | 2x18 | 2.5x18 | 3x18 | 4x18 | 5x18 | 6x18 | 8x18 | 10x18 | 12x18 | | | |
| | 1.5x20 | 2x20 | 2.5x20 | 3x20 | 4x20 | 5x20 | 6x20 | 8x20 | 10x20 | 12x20 | | | |
| | | 2x22 | 2.5x22 | 3x22 | 4x22 | 5x22 | 6x22 | 8x22 | 10x22 | 12x22 | 14x22 | 16x22 | |
| | | 2x24 | 2.5x24 | 3x24 | 4x24 | 5x24 | 6x24 | 8x24 | | | | | |
| | | | | | | | | | 10x25 | 12x25 | 14x25 | 16x25 | |
| | | 2x26 | 2.5x26 | 3x26 | 4x26 | 5x26 | 6x26 | 8x26 | | | | | |
| | | 2x28 | 2.5x28 | 3x28 | 4x28 | 5x28 | 6x28 | 8x28 | 10x28 | 12x28 | 14x28 | 16x28 | |
| | | | | | | | | | | | | | |
| | | 2x30 | 2.5x30 | 3x30 | 4x30 | 5x30 | 6x30 | 8x30 | 10x30 | 12x30 | 14x30 | 16x30 | |
| | | | | | 4x32 | 5x32 | 6x32 | 8x32 | 10x32 | 12x32 | 14x32 | 16x32 | |
| | | | | | 4x36 | 5x36 | 6x36 | 8x36 | 10x36 | 12x36 | 14x36 | 16x36 | |
| | | | | | | | | | | | | | |
| | | | | | 4x40 | 5x40 | 6x40 | 8x40 | 10x40 | 12x40 | 14x40 | 16x40 | |
| | | | | | 4x45 | 5x45 | 6x45 | 8x45 | 10x45 | 12x45 | 14x45 | 16x45 | |
| | | | | | 4x50 | 5x50 | 6x50 | 8x50 | 10x50 | 12x50 | 14x50 | 16x50 | |
| | | | | | | | | | | | | | |
| | | | | | | | | 6x55 | 8x55 | 10x55 | 12x55 | 14x55 | 16x55 |
| | | | | | | | | 6x60 | 8x60 | 10x60 | 12x60 | 14x60 | 16x60 |
| | | | | | | | | | 8x65 | 10x65 | 12x65 | 14x65 | 16x65 |
| | | | | | | | | | | | | | |
| | | | | | | | | 8x70 | 10x70 | 12x70 | 14x70 | 16x70 | |
| | | | | | | | | | 10x80 | 12x80 | 14x80 | 16x80 | |
| | | | | | | | | | 10x90 | 12x90 | 14x90 | 16x90 | |
| | | | | | | | | | | | | | |
| | | | | | | | | | | 10x100 | 12x100 | 14x100 | 16x100 |
| | | | | | | | | | | 10x110 | 12x110 | 14x110 | 16x110 |
| | | | | | | | | | | 10x120 | 12x120 | 14x120 | 16x120 |

Ordering Example:
GPHLRG 8x40
 GPHLRG = DIN 1474 Grooved Pin,
 Half Length Reverse Groove
 8 = Ø8 mm diameter
 40 = 40 mm long

Ordering Example:
GPTLCG 8x40
 GPTLCG = DIN 1475 Grooved Pin,
 Third Length Center Groove
 8 = Ø8 mm diameter
 40 = 40 mm long

kn* = Sheer Force



Grooved Pin Stud DIN 1476

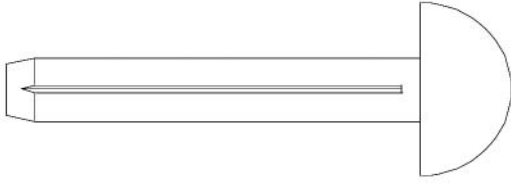

Material: Steel 1.0718 (AISI 12L13)

| Diameter | | | | | | | | | | |
|----------|-------|-------|------|--------|--------|--------|------|------|------|------|
| Ø 1.4 | Ø 1.6 | Ø 1.7 | Ø 2 | Ø 2.3 | Ø 2.5 | Ø 2.6 | Ø 3 | Ø 4 | Ø 5 | Ø 6 |
| 1.4x3 | 1.6x3 | 1.7x3 | 2x3 | 2.3x3 | 2.5x3 | 2.6x3 | | | | |
| 1.4x4 | 1.6x4 | 1.7x4 | 2x4 | 2.3x4 | 2.5x4 | 2.6x4 | 3x4 | | | |
| 1.4x5 | 1.6x5 | 1.7x5 | 2x5 | 2.3x5 | 2.5x5 | 2.6x5 | 3x5 | | | |
| | 1.6x6 | 1.7x6 | 2x6 | 2.3x6 | 2.5x6 | 2.6x6 | 3x6 | 4x6 | 5x8 | 6x8 |
| | | | 2x8 | 2.3x8 | 2.5x8 | 2.6x8 | 3x8 | 4x8 | 5x10 | 6x10 |
| | | | 2x10 | 2.3x10 | 2.5x10 | 2.6x10 | 3x10 | 4x10 | 5x12 | 6x12 |
| | | | | | | | 3x12 | 4x12 | 5x14 | 6x14 |
| | | | | | | | 3x15 | 4x15 | 5x16 | 6x16 |
| | | | | | | | | 4x18 | 5x18 | 6x18 |
| | | | | | | | | 4x20 | 5x20 | 6x20 |
| | | | | | | | | | 5x25 | 6x25 |
| | | | | | | | | | | 6x30 |

Ordering Example:

GPTLCG 8x40

GPTLCG = DIN 1475 Grooved Pin,

Third Length Center Groove

8 = Ø8 mm diameter

40 = 40 mm long

Taper Pins with External Threads and Constant Threaded Part DIN 7977 ISO 8737

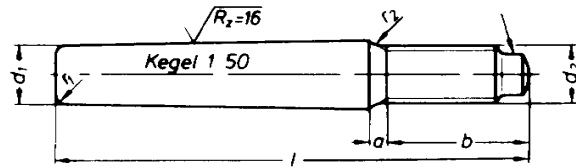

Material: Steel 1.0718 (AISI 12L13)

| | | Diameter | | | | | | | | |
|----|------|----------|-------|--------|--------|--------|--------|--------|--------|------|
| | | Ø 5 | Ø 6 | Ø 8 | Ø 10 | Ø 12 | Ø 13 | Ø 14 | Ø 16 | Ø 20 |
| b | 14 | 18 | 22 | 24 | 27 | | | 30 | 35 | 35 |
| a | 2.4 | 3 | 4 | 4.5 | 5.3 | | | 6 | 6 | 6 |
| d2 | M 5 | M 6 | M 8 | M 10 | M 12 | | | M 12 | M 16 | M 16 |
| | 5x40 | 6x40 | 8x40 | | | | | | | |
| | 5x45 | 6x45 | 8x45 | | | | | | | |
| | 5x50 | 6x50 | 8x50 | 10x50 | | | | | | |
| | 5x60 | 6x55 | 8x55 | | | | | | | |
| | | 6x60 | 8x60 | 10x60 | | | | | | |
| | | 6x65 | 8x65 | 10x65 | 12x65 | 13x65 | | | | |
| | | 6x70 | 8x70 | 10x70 | | | | | | |
| | | 6x75 | 8x75 | 10x75 | 12x75 | 13x75 | 14x75 | 16x75 | | |
| | | 6x80 | 8x80 | 10x80 | | | | | | |
| | | 6x85 | 8x85 | 10x85 | 12x85 | 13x85 | 14x85 | 16x85 | | |
| | | | 8x100 | 10x100 | 12x100 | 13x100 | 14x100 | 16x100 | 20x100 | |
| | | | 8x120 | 10x120 | 12x120 | | 14x120 | 16x120 | 20x120 | |
| | | | | | | | | 16x140 | 20x140 | |
| | | | | | | | | 16x160 | 20x160 | |

Ordering Example:

TPTE 8x40

TPTE = DIN 7977 Taper Pins,

External Threads

8 = Ø8 mm diameter

40 = 40 mm long

Taper Pins with Internal Threads

DIN 7978 A ISO 8736

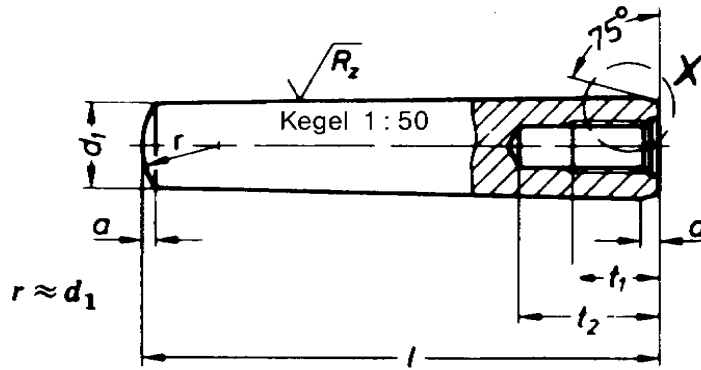

Material: Steel 1.0718 (AISI 12L13)

| | | Diameter | | | | | | | | | | |
|----|------|----------|-------|-------|--------|--------|--------|--------|--------|--------|--------|------|
| | | Ø 4 | Ø 5 | Ø 6 | Ø 8 | Ø 10 | Ø 12 | Ø 13 | Ø 14 | Ø 16 | Ø 20 | Ø 25 |
| a | | | | 0.8 | 1 | 1.2 | 1.6 | | 1.6 | 2 | 2.5 | 3 |
| d2 | | | | M 4 | M 5 | M 6 | M 8 | | M 8 | M 10 | M 12 | M 16 |
| t1 | | | | 6 | 8 | 10 | 12 | | 12 | 16 | 18 | 24 |
| t2 | | | | 10 | 12 | 16 | 20 | | 20 | 25 | 27 | 34 |
| | 4x16 | 5x16 | 6x16 | | | | | | | | | |
| | 4x20 | 5x20 | 6x20 | 8x20 | | | | | | | | |
| | 4x24 | 5x24 | 6x24 | 8x24 | 10x24 | | | | | | | |
| | | | 6x26 | 8x26 | | | | | | | | |
| | | | 6x28 | 8x28 | 10x28 | | | | | | | |
| | 4x30 | 5x30 | 6x30 | 8x30 | 10x30 | | | | | | | |
| | 4x32 | 5x32 | 6x32 | 8x32 | 10x32 | 12x32 | | | | | | |
| | | | 6x36 | 8x36 | 10x36 | 12x36 | | | | | | |
| | 4x40 | 5x40 | 6x40 | 8x40 | 10x40 | 12x40 | 13x40 | 14x40 | 16x40 | 20x40 | | |
| | | | 6x45 | 8x45 | 10x45 | 12x45 | | 14x45 | 16x45 | | | |
| | 4x50 | 5x50 | 6x50 | 8x50 | 10x50 | 12x50 | 13x50 | 14x50 | 16x50 | 20x50 | | |
| | | | 6x55 | 8x55 | 10x55 | 12x55 | | 14x55 | 16x55 | | | |
| | 4x60 | 5x60 | 6x60 | 8x60 | 10x60 | 12x60 | 13x60 | 14x60 | 16x60 | 20x60 | 25x60 | |
| | | | 6x70 | 8x70 | 10x70 | 12x70 | 13x70 | 14x70 | 16x70 | 20x70 | 25x70 | |
| | | | 6x80 | 8x80 | 10x80 | 12x80 | 13x80 | 14x80 | 16x80 | 20x80 | 25x80 | |
| | | | 6x90 | 8x90 | 10x90 | 12x90 | | 14x90 | 16x90 | 20x90 | 25x90 | |
| | | | 6x100 | 8x100 | 10x100 | 12x100 | 13x100 | 14x100 | 16x100 | 20x100 | 25x100 | |
| | | | | 8x110 | 10x110 | 12x110 | | | 16x110 | 20x110 | | |
| | | | | 8x120 | 10x120 | 12x120 | | 14x120 | 16x120 | 20x120 | 25x120 | |
| | | | | | | 12x130 | | | 16x130 | | | |

Ordering Example:

GPS 4x20

GPS = DIN 1476 Grooved Pin Stud

4 = Ø4 mm diameter

20 = 20 mm long

Precision Dowel Pins, Hardened and Ground with Internal Threads

DIN 7979 D ISO 8733

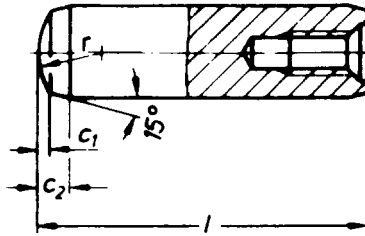

Material: Steel 1.3505 (AISI 52100) Hardness: HRC 60±2

| | | Diameter | | | | | | | | | |
|----|------|----------|-----|------|-------|--------|--------|--------|--------|--------|--------|
| | | Ø 4 | Ø 5 | Ø 6 | Ø 8 | Ø 10 | Ø 12 | Ø 14 | Ø 16 | Ø 20 | Ø 25 |
| c1 | | | | 0.5 | 0.8 | 1 | 1.2 | 1.4 | 1.6 | 2 | 2.5 |
| c2 | | | | 2.1 | 2.6 | 3 | 3.8 | 4 | 4.7 | 6 | 6 |
| d2 | | | | M 4 | M 6 | M 6 | M 6 | M 8 | M 8 | M 10 | M 16 |
| | 4x10 | 5x10 | | | | | | | | | |
| | 4x12 | 5x12 | | | | | | | | | |
| | 4x14 | 5x14 | | 6x12 | | | | | | | |
| | | | | 6x14 | | | | | | | |
| | 4x16 | 5x16 | | 6x16 | 8x16 | 10x16 | | | | | |
| | | 5x18 | | 6x18 | 8x18 | | | | | | |
| | 4x20 | 5x20 | | 6x20 | 8x20 | 10x20 | 12x20 | | | | |
| | | | | | | | | | | | |
| | 4x24 | 5x24 | | 6x24 | 8x24 | 10x24 | 12x24 | | | | |
| | 4x28 | 5x28 | | 6x28 | 8x28 | 10x28 | 12x28 | 14x28 | | | |
| | 4x30 | 5x30 | | 6x30 | 8x30 | 10x30 | 12x30 | | | | |
| | | | | | | | | | | | |
| | 4x32 | 5x32 | | 6x32 | 8x32 | 10x32 | 12x32 | 14x32 | 16x32 | 20x32 | |
| | 4x36 | 5x36 | | 6x36 | 8x36 | 10x36 | 12x36 | 14x36 | 16x36 | 20x36 | |
| | 4x40 | 5x40 | | 6x40 | 8x40 | 10x40 | 12x40 | 14x40 | 16x40 | 20x40 | |
| | | | | | | | | | | | |
| | 4x50 | 5x45 | | 6x45 | 8x45 | 10x45 | 12x45 | 14x45 | 16x45 | 20x45 | |
| | | 5x50 | | 6x50 | 8x50 | 10x50 | 12x50 | 14x50 | 16x50 | 20x50 | 25x50 |
| | | | | 6x55 | 8x55 | 10x55 | 12x55 | 14x55 | 16x55 | 20x55 | |
| | | | | | | | | | | | |
| | | | | 6x60 | 8x60 | 10x60 | 12x60 | 14x60 | 16x60 | 20x60 | 25x60 |
| | | | | 6x70 | 8x70 | 10x70 | 12x70 | 14x70 | 16x70 | 20x70 | 25x70 |
| | | | | 6x80 | 8x80 | 10x80 | 12x80 | 14x80 | 16x80 | 20x80 | 25x80 |
| | | | | | | | | | | | |
| | | | | | 8x90 | 10x90 | 12x90 | 14x90 | 16x90 | 20x90 | 25x90 |
| | | | | | 8x100 | 10x100 | 12x100 | 14x100 | 16x100 | 20x100 | 25x100 |
| | | | | | | 10x120 | 12x120 | 14x120 | 16x120 | 20x120 | 25x120 |

Ordering Example:

DPHTI 8x40

DPHTI = DIN 7979 D Dowel Pin,
Hardened, Internal Threads

8 = Ø8 mm diameter

40 = 40 mm long



Rolled Pins DIN 1481

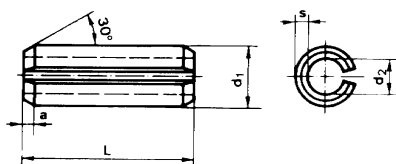

Material Spring Steel Hardness: HRC 42-51

| Diameter | | | | | | | | | |
|----------|------|--------|------|------|------|------|-------|--------|--------|
| Ø 1.5 | Ø 2 | Ø 2.5 | Ø 3 | Ø 4 | Ø 5 | Ø 6 | Ø 8 | Ø 10 | Ø 12 |
| 1.5x6 | 2x6 | 2.5x6 | 3x6 | 4x6 | | | | | |
| 1.5x8 | 2x8 | 2.5x8 | 3x8 | 4x8 | | | | | |
| 1.5x10 | 2x10 | 2.5x10 | 3x10 | 4x10 | 5x10 | 6x10 | | | |
| 1.5x12 | 2x12 | 2.5x12 | 3x12 | 4x12 | 5x12 | 6x12 | | | |
| 1.5x14 | 2x14 | 2.5x14 | 3x14 | 4x14 | 5x14 | 6x14 | | | |
| | 2x15 | | 3x15 | | | | | | |
| 1.5x16 | 2x16 | 2.5x16 | 3x16 | 4x16 | 5x16 | 6x16 | 8x16 | | |
| 1.5x18 | 2x18 | 2.5x18 | 3x18 | 4x18 | 5x18 | 6x18 | 8x18 | | |
| 1.5x20 | 2x20 | 2.5x20 | 3x20 | 4x20 | 5x20 | 6x20 | 8x20 | 10x20 | 12x20 |
| 1.5x22 | 2x22 | 2.5x22 | 3x22 | 4x22 | 5x22 | 6x22 | 8x22 | 10x22 | |
| 1.5x24 | 2x24 | 2.5x24 | 3x24 | 4x24 | 5x24 | 6x24 | 8x24 | 10x24 | 12x24 |
| 1.5x25 | 2x25 | 2.5x25 | 3x25 | 4x25 | 5x25 | 6x25 | 8x25 | 10x25 | 12x25 |
| 1.5x26 | 2x26 | 2.5x26 | 3x26 | 4x26 | 5x26 | 6x26 | 8x26 | 10x26 | 12x26 |
| | | 2.5x28 | 3x28 | 4x28 | 5x28 | 6x28 | 8x28 | 10x28 | |
| | | 2.5x30 | 3x30 | 4x30 | 5x30 | 6x30 | 8x30 | 10x30 | 12x30 |
| | | 2.5x32 | 3x32 | 4x32 | 5x32 | 6x32 | 8x32 | 10x32 | 12x32 |
| | | 2.5x35 | 3x35 | 4x35 | 5x35 | 6x35 | 8x35 | 10x35 | 12x35 |
| | | 2.5x36 | 3x36 | 4x36 | 5x36 | 6x36 | 8x36 | 10x36 | 12x36 |
| | | 2.5x40 | 3x40 | 4x40 | 5x40 | 6x40 | 8x40 | 10x40 | 12x40 |
| | | | 3x45 | 4x45 | 5x45 | 6x45 | 8x45 | 10x45 | 12x45 |
| | | | 3x50 | 4x50 | 5x50 | 6x50 | 8x50 | 10x50 | 12x50 |
| | | | | | 5x55 | 6x55 | 8x55 | 10x55 | 12x55 |
| | | | | | | 6x60 | 8x60 | 10x60 | 12x60 |
| | | | | | | 6x65 | 8x65 | 10x65 | 12x65 |
| | | | | | | 6x70 | 8x70 | 10x70 | 12x70 |
| | | | | | | 6x75 | 8x75 | 10x75 | 12x75 |
| | | | | | | 6x80 | 8x80 | 10x80 | 12x80 |
| | | | | | | 6x85 | 8x85 | 10x85 | 12x85 |
| | | | | | | | 8x90 | 10x90 | 12x90 |
| | | | | | | | | 10x95 | 12x95 |
| | | | | | | | 8x100 | 10x100 | 12x100 |
| | | | | | | | | | 12x110 |
| | | | | | | | | | 12x120 |

Ordering Example:

RP 3x6
 RP = DIN 1481 Rolled Pin
 3 = Ø3 mm diameter
 6 = 6 mm long

Rolled Pins DIN 1481

Stainless Steel

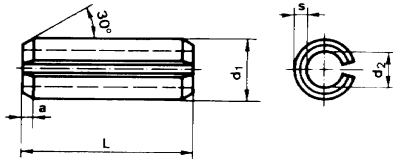

Material Stainless Steel Hardness: HRC 42-51

| Diameter | | | | | | | | |
|----------|------|--------|------|------|------|------|------|-------|
| Ø 1.5 | Ø 2 | Ø 2.5 | Ø 3 | Ø 4 | Ø 5 | Ø 6 | Ø 8 | Ø 10 |
| 1.5x6 | 2x6 | 2.5x6 | 3x6 | 4x6 | | | | |
| 1.5x8 | 2x8 | 2.5x8 | 3x8 | 4x8 | | | | |
| 1.5x10 | 2x10 | 2.5x10 | 3x10 | 4x10 | 5x10 | | | |
| 1.5x12 | 2x12 | 2.5x12 | 3x12 | 4x12 | 5x12 | 6x12 | | |
| 1.5x14 | 2x14 | 2.5x14 | 3x14 | 4x14 | 5x14 | 6x14 | | |
| | 2x15 | | 3x15 | 4x15 | | | | |
| 1.5x16 | 2x16 | 2.5x16 | 3x16 | 4x16 | 5x16 | 6x16 | | |
| 1.5x18 | 2x18 | 2.5x18 | 3x18 | 4x18 | 5x18 | 6x18 | | |
| 1.5x20 | 2x20 | 2.5x20 | 3x20 | 4x20 | 5x20 | 6x20 | 8x20 | |
| 1.5x22 | 2x22 | 2.5x22 | 3x22 | 4x22 | 5x22 | 6x22 | 8x22 | |
| 1.5x24 | 2x24 | 2.5x24 | 3x24 | 4x24 | 5x24 | 6x24 | 8x24 | |
| 1.5x25 | 2x25 | 2.5x25 | 3x25 | 4x25 | 5x25 | 6x25 | 8x25 | |
| 1.5x26 | 2x26 | 2.5x26 | 3x26 | 4x26 | 5x26 | 6x26 | 8x26 | |
| | | 2.5x28 | 3x28 | 4x28 | 5x28 | 6x28 | 8x28 | |
| | | 2.5x30 | 3x30 | 4x30 | 5x30 | 6x30 | 8x30 | |
| | | 2.5x32 | 3x32 | 4x32 | 5x32 | 6x32 | 8x32 | |
| | | 2.5x35 | 3x35 | 4x35 | 5x35 | 6x35 | 8x35 | |
| | | 2.5x36 | 3x36 | 4x36 | 5x36 | 6x36 | 8x36 | |
| | | 2.5x40 | 3x40 | 4x40 | 5x40 | 6x40 | 8x40 | |
| | | | 3x45 | 4x45 | 5x45 | 6x45 | 8x45 | |
| | | | 3x50 | 4x50 | 5x50 | 6x50 | 8x50 | |
| | | | | | | 6x55 | 8x55 | |
| | | | | | | 6x60 | 8x60 | |
| | | | | | | 6x65 | 8x65 | |
| | | | | | | 6x70 | 8x70 | |
| | | | | | | 6x75 | 8x75 | |
| | | | | | | 6x80 | 8x80 | |
| | | | | | | | | 10x85 |
| | | | | | | | | 10x90 |

Ordering Example:

RP 3x6 SS

RP = DIN 1481 Rolled Pin

3 = Ø3 mm diameter

6 = 6 mm long

SS = Stainless Steel



Cotter (Split) Pins

DIN 94/ISO 1234

Material: Carbon Steel
Finish: Zinc Plated

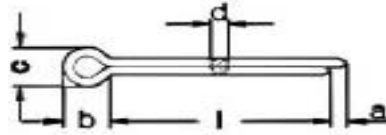

All Dimensions in mm

| Diameter | 0.8 | 1.0 | 1.2 | 1.6 | 2.0 | 2.5 | 3.2 | 4.0 | 5.0 | 6.3 | 8.0 | 10.0 | 13.0 |
|-------------|-----|-----|-----|-----|-----|-----|-----|-----|-----|------|------|------|------|
| a max. | 1.6 | 1.6 | 2.5 | 2.5 | 2.5 | 2.5 | 3.2 | 4 | 4 | 4 | 4 | 6.3 | 6.3 |
| b | 2.4 | 3 | 3 | 3.2 | 4 | 5 | 6.4 | 8 | 10 | 12.6 | 16 | 20 | 26 |
| c min. | 1.2 | 1.6 | 1.7 | 2.4 | 3.2 | 4 | 5.1 | 6.5 | 8 | 10.3 | 13.1 | 16.6 | 21.7 |
| c max. | 1.4 | 1.8 | 2 | 2.8 | 3.6 | 4.6 | 5.8 | 7.4 | 9.2 | 11.8 | 15 | 19 | 24.8 |
| Length (mm) | | | | | | | | | | | | | |
| 6 | | | | | | | | | | | | | |
| 8 | | | | | | | | | | | | | |
| 10 | | X | | X | X | | | | | | | | |
| 12 | | X | | X | X | | | | | | | | |
| 14 | | X | | X | X | X | | | | | | | |
| 16 | | X | | X | X | X | X | | | | | | |
| 18 | | X | | X | X | X | X | | | | | | |
| 20 | | X | | X | X | X | X | X | X | | | | |
| 22 | | | | X | X | X | X | X | X | | | | |
| 25 | | | | X | X | X | X | X | X | X | | | |
| 28 | | | | X | X | X | X | X | X | X | | | |
| 32 | | | | X | X | X | X | X | X | X | | | |
| 36 | | | | X | X | X | X | X | X | X | | | |
| 40 | | | | X | X | X | X | X | X | X | | | |
| 45 | | | | X | X | X | X | X | X | X | X | | |
| 50 | | | | | X | X | X | X | X | X | X | | |
| 56 | | | | | | X | X | X | X | X | X | X | X |
| 63 | | | | | | | X | X | X | X | X | X | X |
| 71 | | | | | | | | X | X | X | X | X | X |
| 80 | | | | | | | | X | X | X | X | X | X |
| 90 | | | | | | | | X | X | X | X | X | X |
| 100 | | | | | | | | | X | X | X | X | X |
| 112 | | | | | | | | | | X | X | X | X |
| 125 | | | | | | | | | | | X | X | X |
| 140 | | | | | | | | | | | | X | X |
| 160 | | | | | | | | | | | | | X |
| 180 | | | | | | | | | | | | | X |
| 200 | | | | | | | | | | | | | X |

Note: X = Standard Item

Ordering Example:

CP 4X25

CP = DIN/ISO 1234 Cotter Pin

4 = Ø4 mm diameter

25 = 25 mm long



American Me

GROUP: 063

GROUP: 063

1-063 - 060220